

标记 MARK.	ECN编号/变更内容 ECN NO./DEFINITION	日期 DATE	修改 REVISE	核准 APPROVE

H:	2.5	3.5	5.0
A:	0.6	0.7	
B:	A+0.4		

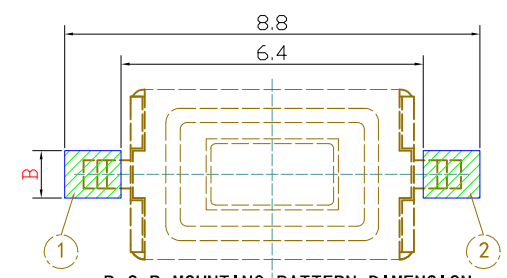
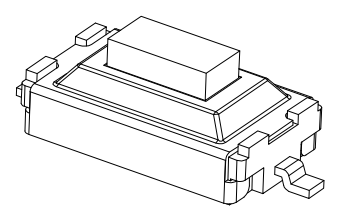
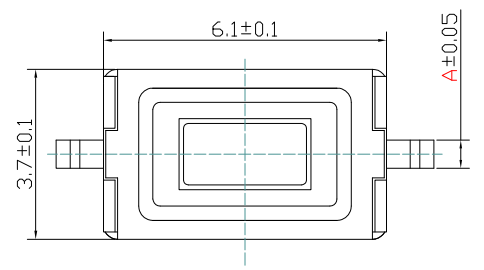
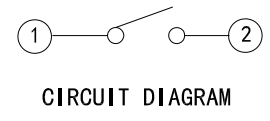
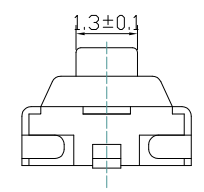
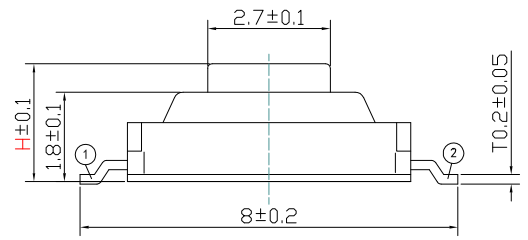

P. C. B MOUNTING PATTERN DIMENSION
the following soldering are recommended for reflow soldering

项目	规格	未标注公差列表				单位: UNIT	mm	产品系列 Product series	轻触开关
额定电负荷:	DC12V 50mA	X.	±0.2	X.°	±1°	材质 MATERIAL		产品名称 Product Title	
绝缘电阻:	≥100MΩ 100V DC/1min	.X	±0.1	.X°	±0.5°	重量 WT.		产品编码 Product number	
耐压强度:	AC250V 50Hz/1min	.XX	±0.05	.XX°	±0.3°	图号 DWG NO.			
环境温度:	-40℃ ~ +85℃	.XXX	±0.02	.XXX°	—	视图 VIEW	比例 SCALE	1 : 1	
接触电阻:	≤100mΩ Max	设计 DESIGN				校核 CHECKED	版本 REV.	A0	
行程:	0.25±0.1mm	校准化 STANDARD				批准 APPROVE			
						日期	2020/03		

东莞市溪榜电子有限公司
DONG GUAN XI BANG ELECTRONICS CO., LTD.